



JULY 2023

PIPE EQUIPMENT SPECIALISTS

## PREP 16 PIPE BEVELLING 3" to 16" MANUAL

SCAN QR CODE  
TO WATCH VIDEO

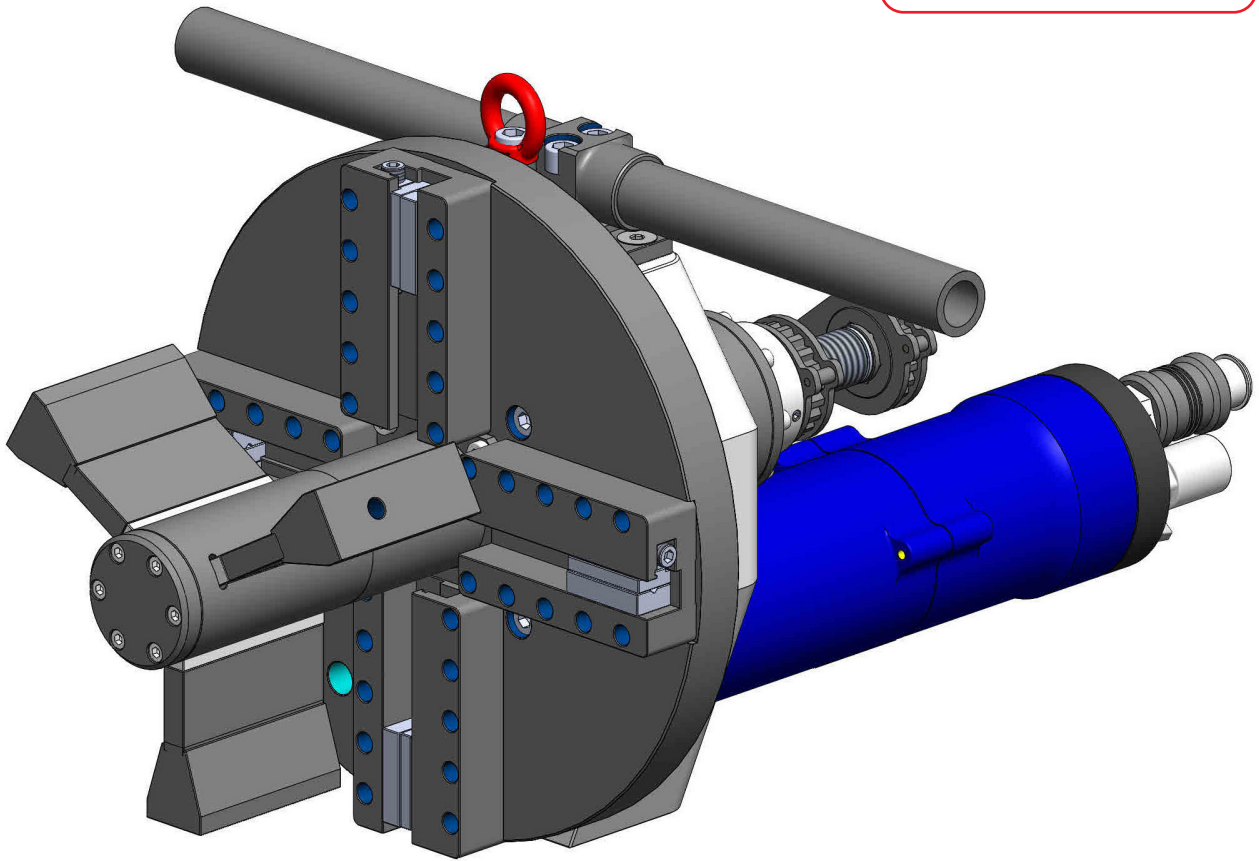
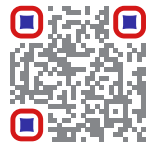



## SPECIALIZED FABRICATION EQUIPMENT GROUP

### S.F.E. GROUP - INTERNATIONAL TERMS AND CONDITIONS

S.F.E. GROUP - INTERNATIONAL HEREINAFTER REFERRED TO AS S.F.E. GROUP

CONDITIONS OF SALE (APRIL 2023)

These conditions of sale override any clauses in buyers' purchase orders and in any other communications if in conflict therewith.

**PRICES** - All prices are quoted ex-works, **S.F.E. Group** reserves the right to alter the prices of the terms offered to any buyer without notice. Prices and terms shall be those ruling at the date of despatch. All prices quoted are ex-works **S.F.E. Group France** (unless stated otherwise).

**MINIMUM ORDER CHARGE** - There is a minimum order charge of **£250.00 / €275.00 / \$300.00**

**CARRIAGE & PACKING** - The Company reserves the right as part of this contract to impose such surcharge or carriage charge as shall be laid down by the Company policy at any time. The Company has sole choice of method of delivery and of carrier employed unless specifically agreed in writing to the contrary.

**PAYMENT TERMS** - The Company's standard terms of payment are nett cash 30 days. New customers will be subject to proforma payment. Overdue invoices may be subject to interest charge at 5% above bank base lending rate.

**DELIVERY** - Time for delivery is given as accurately as possible. The customer shall have no right to damages or to cancel the order for failure for any cause to meet any delivery time stated. All dispatch times quoted are subject to prior sales.

**DAMAGE/LOSS IN TRANSIT** - (1) The Company accepts no liability for any damage to goods in transit unless notified to the Company and the carrier concerned within five days after delivery. (2) In the case of non-delivery the Company accepts no liability of any sort unless written notice of non-delivery is given to the Company within twelve days after the date of the advice of despatch. (3) The Company's liability for damage in transit or non-delivery of goods duly notified to it in accordance with the above, shall in any event be limited solely to replacement of the goods within a reasonable time, whether non-delivery or damage is due to the Company's negligence or otherwise.

**RETENTION OF TITLE** - (1) Until **S.F.E. Group** has been paid in full for the goods comprised in this or any other contract between them, the goods comprised in the contract remain the property of **S.F.E. Group** although the risk passes to the buyer at the point of delivery in the contract. (2) If the buyer fails to pay for the goods on the due date or commits any act of bankruptcy or if any resolution of petition to wind-up the buyer's business shall be passed (other than for the purposes of amalgamation or reconstruction) or if a receiver of the buyer's undertakings is appointed **S.F.E. Group** may recover possession of the goods at any time from the buyer and for that purpose **S.F.E. Group**, our servants or agents may enter upon any land or building upon which the goods are situated. (3) The buyer has a right to dispose of the goods in the course of his business for the account of **S.F.E. Group** and to pass good title to the goods to his customer being a bona fide purchaser for value without notice of **S.F.E. Group** rights. In the event of such disposal the buyer has the fiduciary duty to **S.F.E. Group** to account to **S.F.E. Group** for the proceeds (which shall be kept separate and identifiable from the buyer's own monies) but may retain therefrom an excess of such proceeds over the amount outstanding under this or any sale contract between them.

**GUARANTEE** - **S.F.E. Group** agrees to replace or repair at its option goods or parts manufactured by **S.F.E. Group** and proved to be defective due to faulty workmanship within a period of 12 months from the date of invoice (fair wear and tear or damage due to misuse of faulty operation excepted). The Warranty contained in the previous paragraph does not extend to any equipment not manufactured by **S.F.E. Group**, although supplied by **S.F.E. Group**, nor does it extend to any second hand or reconditioned goods. Equipment not manufactured by **S.F.E. Group** carry only the Warranty (if any) of their makers and the purchaser is entitled to the benefit thereof only so far as **S.F.E. Group** have the power to transfer it.

**LIABILITY** - (1) The Buyer agrees that apart from the express terms contained herein or in the quotation or in any document expressly stipulated therein to form part of the contract and to be outside the provisions of this clause no statement or representation has been made by **S.F.E. Group** relating to the goods supplied, or if any such statement of representation has been made the buyer warrants that he understood it to be a statement of opinion only, and did not rely on. (2) No liability is accepted for any direct or indirect costs, damages or expenses relating to damage to property or injury or loss of any person, firm or company or for any loss of profits or production arising out of or occasioned by any defect in or failure of goods or materials or parts thereof supplied by **S.F.E. Group**. (3) **S.F.E. Group's** liability, whether in respect of one claim or in the aggregate, arising out of any contract shall not exceed the purchase price payable under contract.

**DATA** - Illustrations, weights, measures, specifications and performance schedules set out in the sales literature of **S.F.E. Group** are statements of opinion and are provided for information only and form no part of the contract.

**CANCELLATION** - Cancellation of an order will not normally be accepted by **S.F.E. Group**. However **S.F.E. Group** may at its discretion agree to cancellation on the strict condition that all costs and expenses incurred by **S.F.E. Group** up to the time of cancellation and all loss of profits and other loss or damage resulting to **S.F.E. Group** by reason of such cancellation will be reimbursed by the customer to **S.F.E. Group** forthwith.

**RETURN OF GOODS** - Goods supplied in accordance with the buyer's order may later be returned to **S.F.E. Group** only with **S.F.E. Group's** permission in writing. For standard stock items the buyer will be required to pay to **S.F.E. Group** a handling charge of 15% of the list price of such returned goods. In the case of special items the handling charge will depend on the value to **S.F.E. Group** of the returned goods.

**HIRE** - For hire terms see hire agreement

**CONTRACT LAW** - This contract will be deemed to be the subject of the law of France.

## TABLE OF CONTENTS

1.	Preface.....	04
2.	Safety Instructions.....	04
3.	General Safety Instructions .....	05
4.	Specific Instructions .....	05
5.	Machine Working Principle.....	06
6.	Machine Technical Data.....	08
7.	Machine Standard Equipment .....	10
8.	Machine Setup and Operation.....	10
8.1	PREP Locking Jaws .....	10
8.2	Tools Setup .....	15
8.3	Operation.....	16
8.4	Drive Kit Replacement .....	17
9.	Periodic Maintenance and Repair .....	19



**SPECIALIZED FABRICATION EQUIPMENT**  
GROUP

*Our group policy is one of continuous improvements and acquisitions.  
Products and data tables are subject to change and may vary from those illustrated.*

### OUR BRANDS



## 1 - PREFACE

This manual provides the essential information and step-by-step guidance to the principle, configuration, installation and usage of the TAG PIPE EQUIPMENT SPECIALISTS LTD's PREP models machine (in short: TAG Pipe and PREP).

The TAG Pipe PREP models are a high-tech portable inside diameter locking cold pipe bevelling machine. The basic functions of the PREP models are the facing, external bevelling, internal bevelling and counterboring of pipes within the selected model's working range (inside diameter). The PREP models can be used on any type of steel and exotic alloys.

The PREP models are available with the following motorizations: pneumatic, hydraulic and servo electric motor. The PREP models configuration are flexible due to its modular character: components and motors can be (within their limitations) exchanged, upgraded and replaced. The PREP models accept a wide range of accessories and bevelling tooling to increase their performance and expand their machining capacities.

Please read the instruction manual carefully before using the equipment.

### NOTE

In the event of queries on installation, commissioning, operation or special conditions at the operation's site, or on usage, please contact your nearest TAG Pipe partner or our customer service department on **+44 (0)1869 324 144**, or via e-mail: **sales@tag-pipe.com**.

### DISCLAIMER

TAG Pipe's liability related to the operation of the PREP models are restricted solely to the function of the equipments. No other form of liability, regardless of type, shall be accepted. This exclusion of liability shall be deemed accepted by the user on commissioning of the equipment. TAG Pipe is unable to monitor whether or not the instructions in this manual or the conditions and methods are observed during installation, operation, usage and maintenance of the PREP. An incorrectly performed installation can result in material damage and injure persons as a result. For this reason, TAG Pipe does not accept any responsibility or liability of losses, damages or costs arising from incorrect installation, improper operation or incorrect usage and maintenance or any actions connected to this in any way possible.

## 2 - SAFETY INSTRUCTIONS

 **WARNING** - TAG Pipe takes great pride in manufacturing safe, quality products with user safety as key priority. TAG Pipe recommends that all users comply with the following safety rules and instructions when operation the PREP models.

For your safety and the safety of others, read and understand these safety recommendations before installing and operating the PREP models. Keep this manual at all time clean and stored safely, accessible for any operator's reference at any time.

The TAG Pipe PREP is a high-tech portable inside diameter locking cold pipe bevelling machine. The basic functions of the PREP are the facing, external bevelling, internal bevelling and counterboring of pipes within the selected model's working range (inside diameter). The PREP can be used on any type of steel and exotic alloys. The PREP can be used on site or in a workshop environment. At all time it is the operator's responsibility to be aware of and adhere to the local applicable rules and legislation related to the operation of the equipment.

Wrong use or abuse of the PREP can lead to lethal accident and/or material damage (not limited to the equipment itself) and the environment.

The PREP should be operated at all time by a qualified operator, who has received adequate training on the equipment. Throughout the operation the operator must be familiar with:

- The controls of the equipment.
- The operation of the equipment.
- General and local safety regulations.
- The technical, physical and practical limitations of the equipment.



### 3 - GENERAL SAFETY INSTRUCTIONS

- Keep working space clean.
- Assess the working conditions properly prior to using the equipment.
- The operator should wear appropriate personal protective equipment when operating the equipment.
- When operating any heavy equipment, it is imperative that the operator is careful and observant of all moving components.
- Keep away from rotating parts during operation of the equipment.
- The operator should be physically and mentally capable of operating the equipment. In case of illness, tiredness or any medical or mental condition limiting the correct and safe operation of the equipment, the operator should be prohibited to conduct any work with the equipment.
- Make sure the grounding is connected properly and electrical cabinets are closed.
- Don't operate the electric switch, or button, or cables with wet hands, for fear of electrical shock. Protect the body from injury due to electric shock by avoiding touching any electrical parts when under power.
- Use only the foreseen earth connection. Do not ground to this equipment as it is possible to short-circuit the motor and/or control box when grounding to this equipment. Improper grounding poses a risk of electrical shock.
- Make sure power supply is disconnected when not operating or executing maintenance on the equipment.
- Do not make any modifications to existing or original electrical circuits, cabinets, safety stops and other related original components.
- Do not operate the equipment before closing all covers of the equipment. Great danger exists in naked terminals of power supply.
- Make sure all power cables are in good condition. In case of wear or damage, replace immediately.
- Don't pull the equipment by its cable(s) and don't disconnect the power cable from the equipment to cut off power. The cable(s) should be kept away from heat, power, oil, dirt and sharp-pointed tools or debris. Check the cable(s) before, during and after every operation.
- Protect yourself from toxic fumes that may be produced during welding operations. Make sure there is appropriate ventilation and/or fume extraction in the working area.
- Wear impact resistant eye and ear protection while operation the equipment. If there is a lot of dust or fumes, wear dust-proof respirator or mask.
- Make sure all of equipment's safety measures, covers and other devices are normal condition and checked.

### 4 - SPECIFIC INSTRUCTIONS

- Use solely original TAG Pipe components, accessories, tooling and (spare) parts.
- The equipment should only be used for its intended purpose.
- Considering the working environment of operation, don't get the equipment unnecessarily wet and don't use the equipment in overly humid conditions. Ensure the machine has the best possible conditions for operation.
- Do not remove or modify any component or part from the original PREP.
- Maintain the equipment regularly. In order to maintain the performance of the machine, keep it clean at all times and add oil lubricant and replace (spare) parts as per periodic recommendations.
- Prior to conducting any maintenance or change of accessories, (spare) parts or tooling, ensure that the power plug or air supply has been disconnected. The machine should not be 'powered' or in 'running mode'.
- When the power supply is connected, consider the machine in 'running mode'. Don't put hands on or near the switch.
- Before using the PREP make sure to inspect the machine on its completeness of all components, proper installation and general condition. In case of any sign of damage, wear or tear replace the affected components or parts prior to using the machine.
- Store and transport the equipment in the designated boxes in order to protect it from damage or deterioration due to environmental conditions.
- The PREP machines shall only be serviced and repaired by TAG Pipe or an authorized TAG Pipe partner.
- Follow carefully the instructions and technical specification related to the motorization of the PREP (voltage input, air pressure, quality of compressed air supply et cetera).
- Check the handle and safety pedal regularly (applied only to pneumatic motorized machines).

## 5 - MACHINE WORKING PRINCIPLE

The TAG Pipe PREP is a high-tech portable inside diameter locking cold pipe bevelling machine. The basic functions of the PREP are the cutting, facing, external bevelling, internal bevelling and counterboring of pipes within the selected model's working range (inside diameter). The PREP can be used on any type of steel and exotic alloys. The PREP can be used on site or in a workshop environment.

The PREP models are available with the following motorizations: pneumatic, hydraulic and servo electric motor. The PREP configuration is flexible due to its modular character: motors can be (within their limitations) exchanged, upgraded and replaced. The PREP models accept a wide range of accessories and cutting and bevelling tooling to increase their performances and expand their machining capacities.

It works while inserted and locked into the ID of the pipe.

The bevel is obtained by bevelling tools of various shape and materials, depending by the nature of the material to be bevelled.

TAG Pipe's PREP's HSS Co (high speed steel with cobalt) range of tooling includes facing, bevel, double-bevel, compound bevel and counter bore tools. TAG tooling is available in a range of different lengths and sizes in order to match precisely the required application. TAG Pipe also offers custom designed tooling, special tool steel, coatings, and inserts for applications not covered by the standard range of tooling.

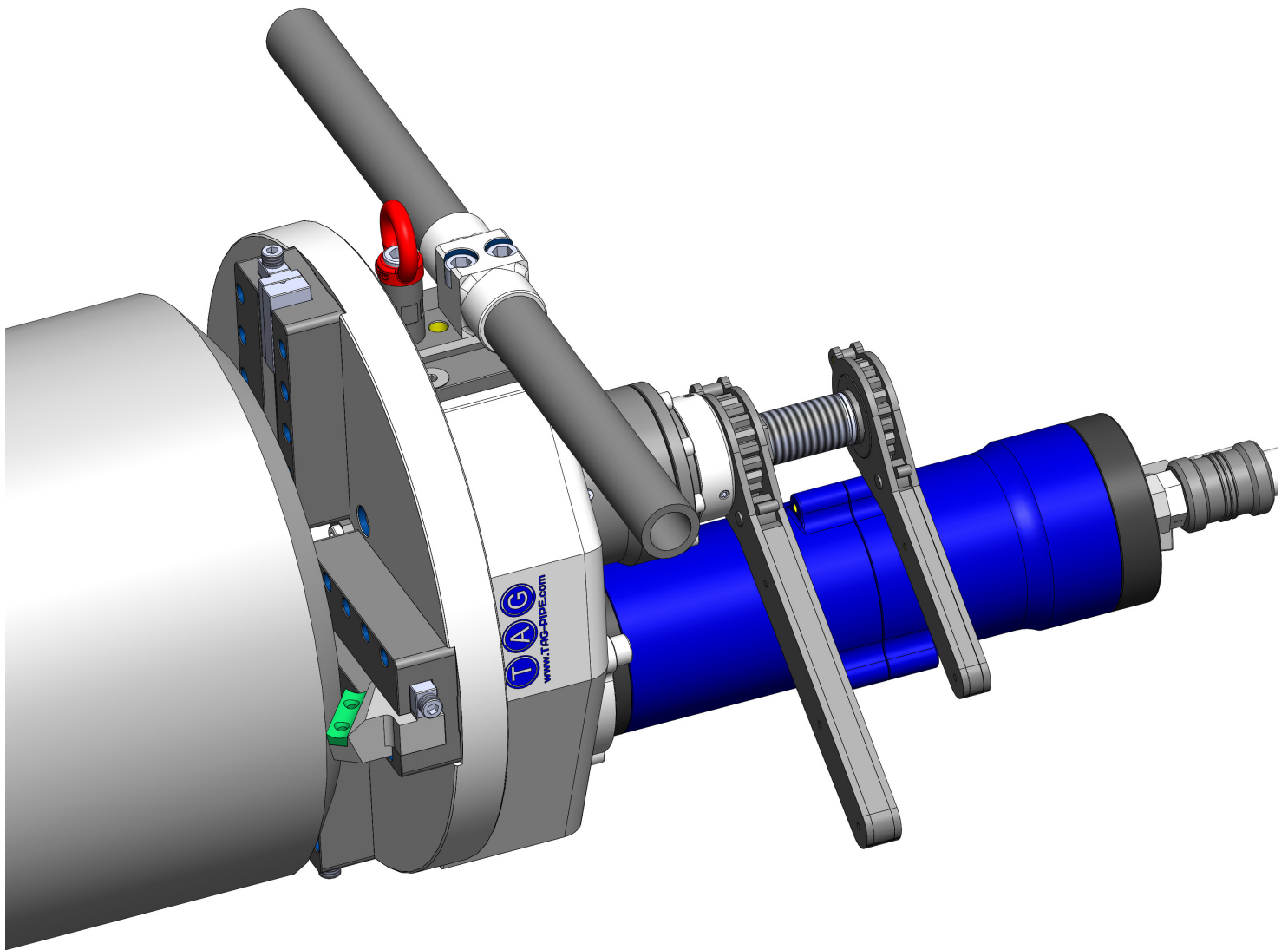

## EXAMPLES OF COMMON CUTTING TOOLS

### FORMED TOOLS



Bevel



Facing



Internal



Compound

**All shapes, sizes and angles available**

### HOLDER / INSERT (Recommended)



Bevel

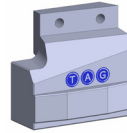

Facing



Internal



Compound

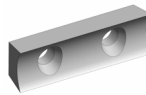

One insert fits ALL holders

The TAG Pipe PREP models are modular in the sense that any of the following motor types can be mounted. This increases the overall user friendliness and flexibility. The motors can be installed and / or exchanged rapidly on the same motor mounting.

The TAG PREP 16 can be equipped with the following motor types:

### PNEUMATIC



### SERVO ELECTRIC

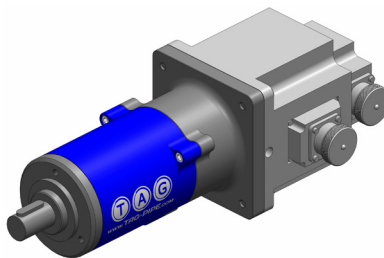

### HYDRAULIC

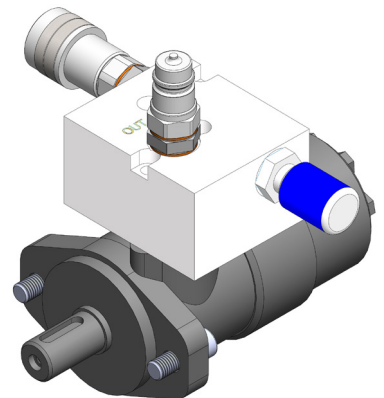

## 6 - MACHINE TECHNICAL DATA

The TAG PREP 16 dimensional specifications.

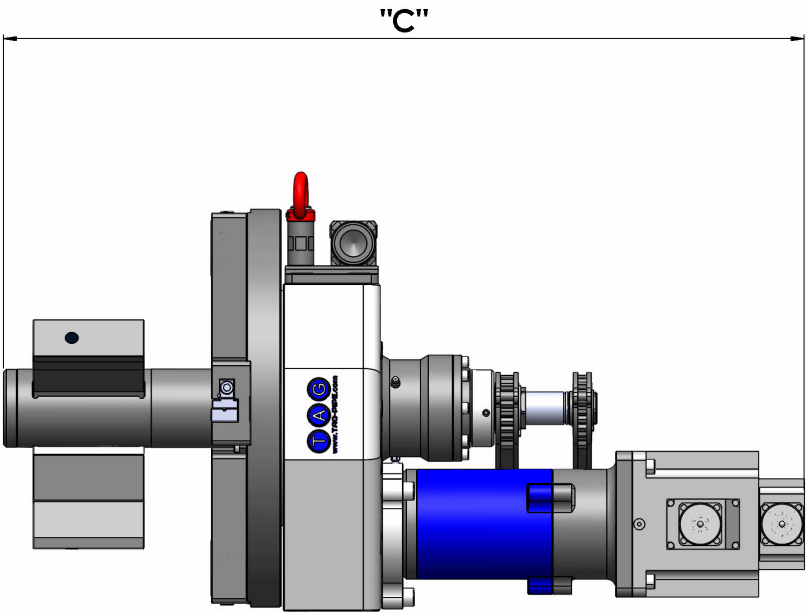
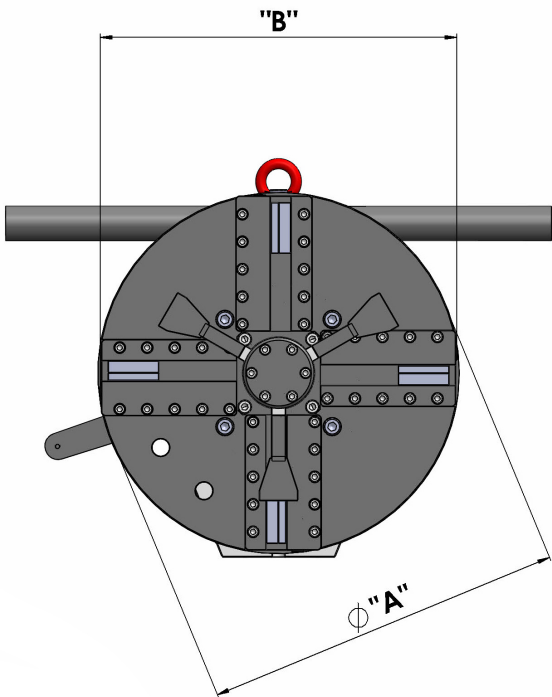

DIM	PNEUMATIC	SERVO ELECTRIC	HYDRAULIC
A	323mm	323mm	323mm
B	407mm	407mm	407mm
ØC	750mm	630mm	530mm

## PREP 16 TECHNICAL FEATURES

DESCRIPTION	MEASUREMENT	PNEUMATIC	SERVO ELECTRIC	HYDRAULIC
Part Number	n/a	TP16P	TP16SE110 / TP16SE220	TP16H
Locking tube range	mm / inch (i/d)	72 - 400 2.8 - 15.74"	72 - 400 2.8 - 15.74"	72 - 400 2.8 - 15.74"
Working range	mm / inch (o/d)	72 - 406 3 - 16"	72 - 406 3 - 16"	72 - 406 3 - 16"
Idle speed	rpm	5 - 18	1 - 18	1 - 26
Length of axial feed	mm / inch	50 / 2	50 / 2	50 / 2
Max operating temperature	°C	55	60	60
Max acoustic radiation	dB	75	45	55
Pneumatic Motor Power	hp	3.5	n/a	5.4
Air Consuming Flux	cfm / l/min.	90 / 2500	n/a	n/a
Air working pressure	psi / bar	90 / 6.5	n/a	n/a
Air Hose Connection	inches	¾"	n/a	n/a
Servo Electric Motor Power	kw	n/a	1.5	n/a
Voltage	volt	n/a	110 or 220	Refer to Hydraulic Power Pack
Frequency	Hz	n/a	50 / 60	Refer to Hydraulic Power Pack
Remote Control	Yes / No	No	Yes	Yes
Forward / Reverse	Yes / No	No	Yes	Yes
Unit weight	kg / lbs	43 / 95	44 / 97	41 / 90
Packing dimensions L x W x H	mm	860 x 570 x 530	860 x 570 x 530	860 x 570 x 530
Packing weight	kg / lbs	128 / 282	140 / 305	125 / 275

*Our group policy is one of continuous improvement. Products and Data Tables are subject to change or vary from those illustrated.*

## 7 - MACHINE STANDARD EQUIPMENT

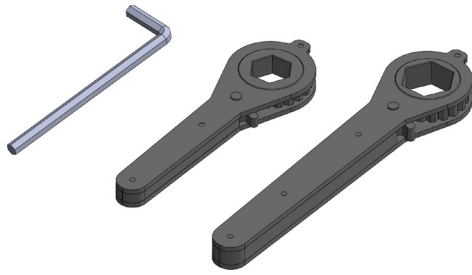

Service Tools

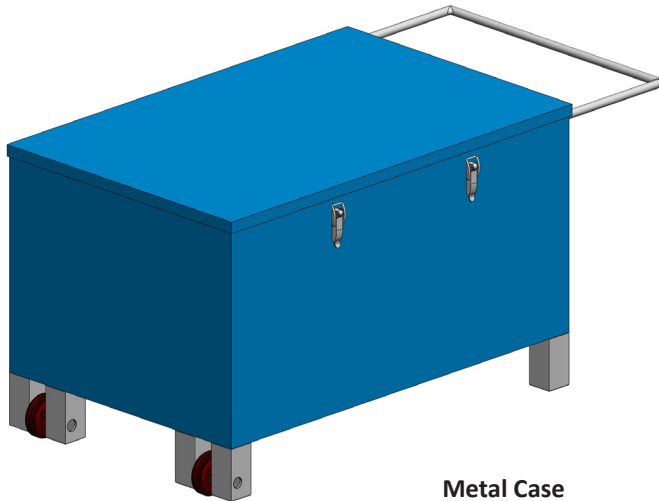

Metal Case



User Manual

## 8 - MACHINE SETUP AND OPERATION

### 8.1 - PREP LOCKING JAWS

Prior to mounting the PREP it is important to measure the inside diameter (in short: I.D.) of the workpiece.

#### STEP 1

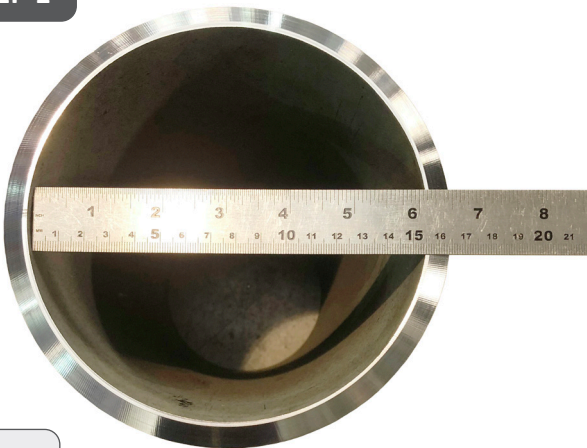

Fig. 1

I.D.

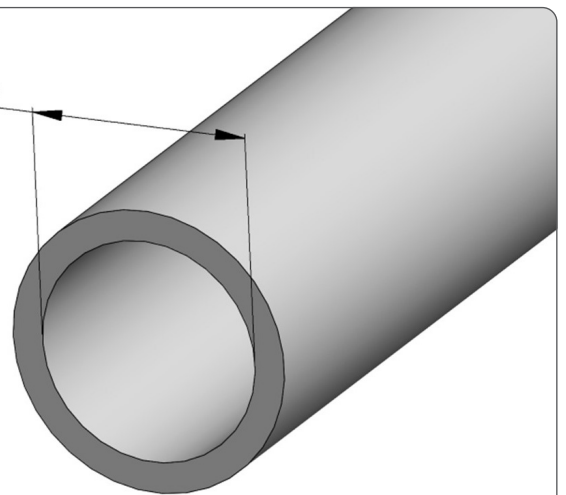
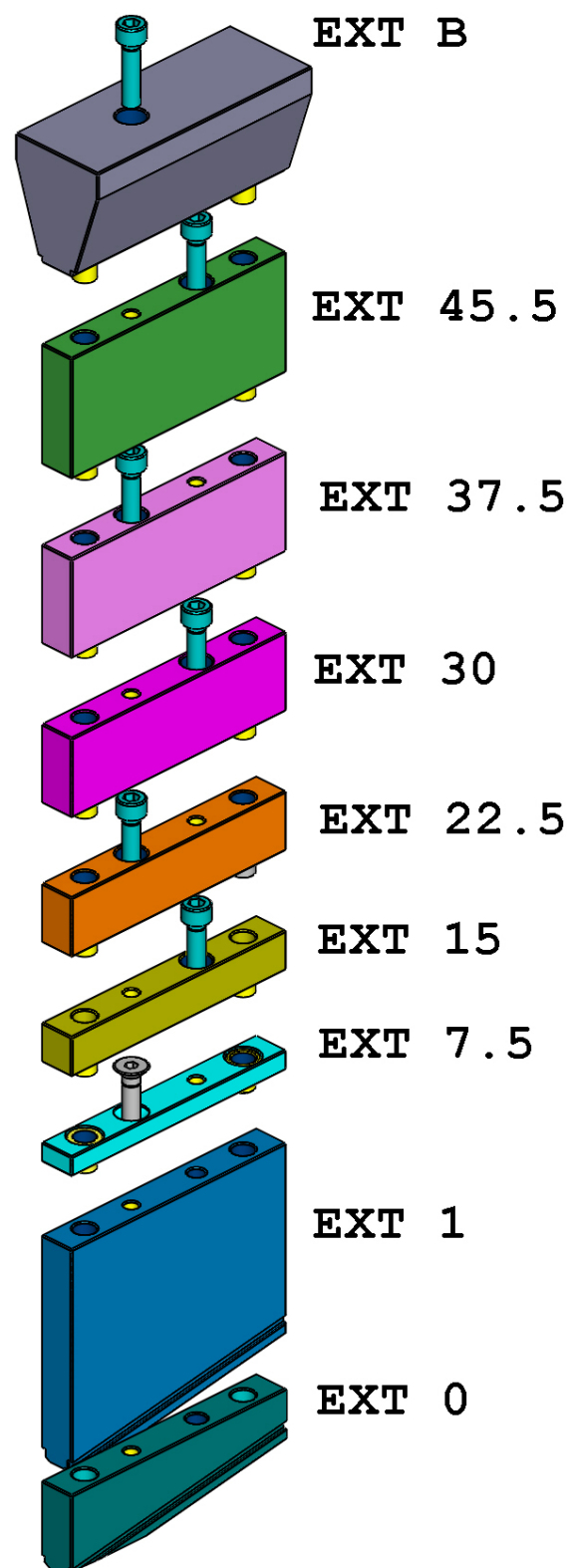

Fig. 2

Find ID. select the combination of Jaws to be used in the complete kit supplied with the machine using the following table.



MIN - MAX	MIN - MAX	JAW 1	JAW 2	JAW 3	JAW 4
72 - 82	2.83 - 3.23	EXT 0			
80 - 98	3.14 - 3.85	EXT 0	EXT 7.5		
96 - 112	3.78 - 4.41	EXT 0	EXT 15		
110 - 127	4.33 - 5.00	EXT 0	EXT 22.5		
125 - 142	4.92 - 5.59	EXT 0	EXT 30		
140 - 157	5.51 - 6.18	EXT 0	EXT 37.5		
156 - 173	6.14 - 6.81	EXT 0			EXT B
171 - 187	6.73 - 7.36	EXT 0	EXT 7.5		EXT B
186 - 202	7.32 - 7.95	EXT 0	EXT 15		EXT B
201 - 217	7.91 - 8.54	EXT 0	EXT 22.5		EXT B
216 - 232	8.50 - 9.13	EXT 0	EXT 30		EXT B
231 - 248	9.09 - 9.76	EXT 0	EXT 37.5		EXT B
247 - 263	9.72 - 10.35	EXT 0		EXT 45.5	EXT B
262 - 277	10.31 - 10.90	EXT 1			EXT B
276 - 292	10.86 - 11.49	EXT 1	EXT 7.5		EXT B
291 - 308	11.45 - 12.12	EXT 1	EXT 15		EXT B
307 - 323	12.08 - 12.71	EXT 1	EXT 22.5		EXT B
322 - 338	12.67 - 13.30	EXT 1	EXT 30		EXT B
337 - 353	13.26 - 13.89	EXT 1	EXT 37.5		EXT B
352 - 368	13.85 - 14.48	EXT 1		EXT 45.5	EXT B
367 - 384	14.44 - 15.11	EXT 1	EXT 7.5	EXT 45.5	EXT B
383 - 400	15.07 - 15.74	EXT 1	EXT 15	EXT 45.5	EXT B



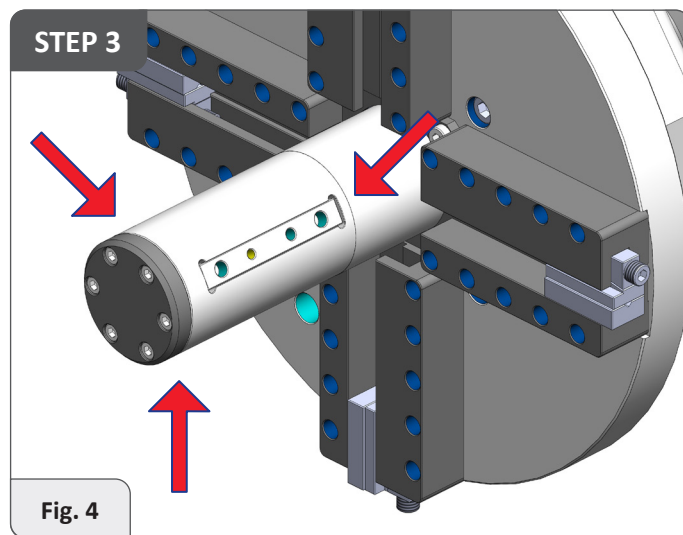
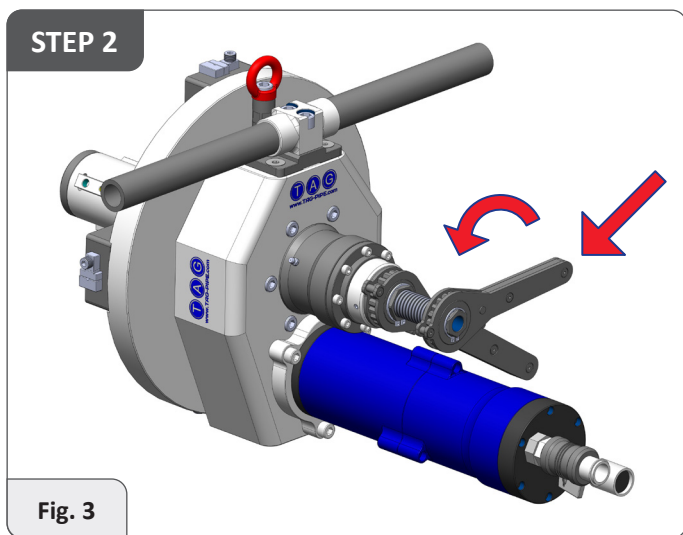

Using the key on the machine and turning it counterclockwise, fully retract all 3 locking blocks. (See figures).

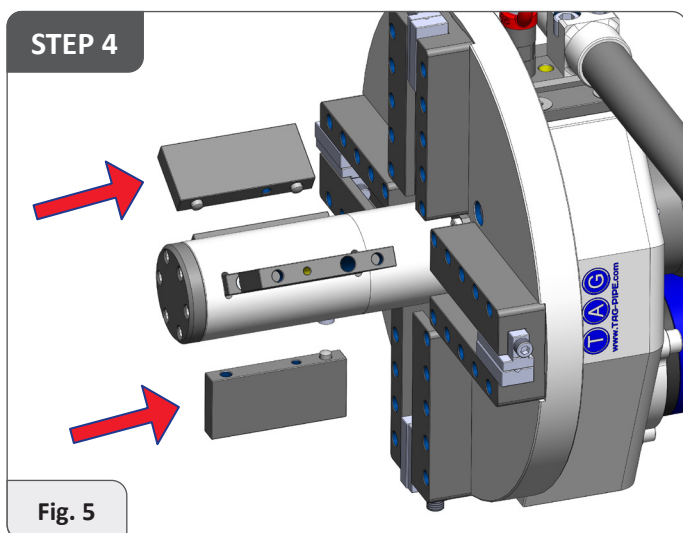

Insert the locking segments/jaws in their seats.

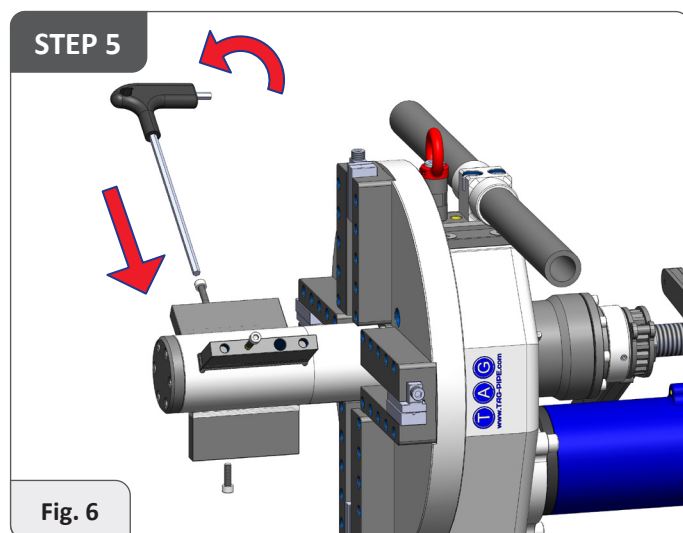

Use the appropriate tool to fix the locking segments.

**⚠** Be very careful not to unscrew too much otherwise the expansion shaft could release from the rear thread.

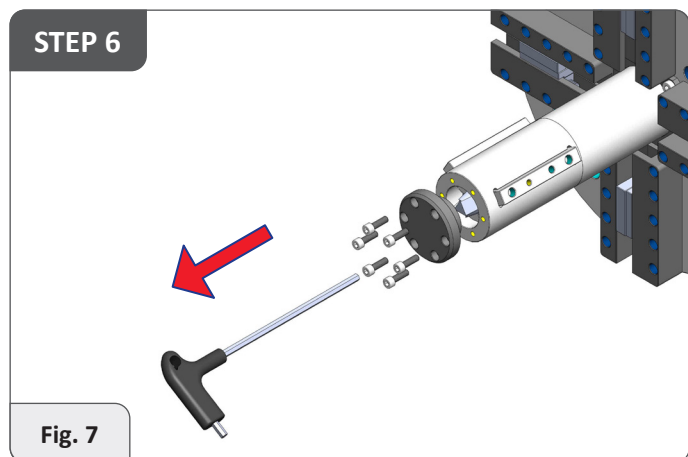

Using the key in the scope of delivery, remove the 6 screws and the cover as shown.

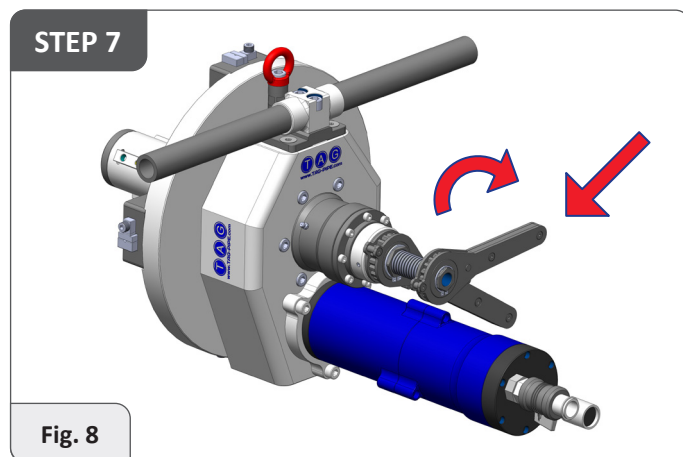

Using the key on the machine, turn clockwise and advance the jaw expansion shaft until the jaws can be removed.

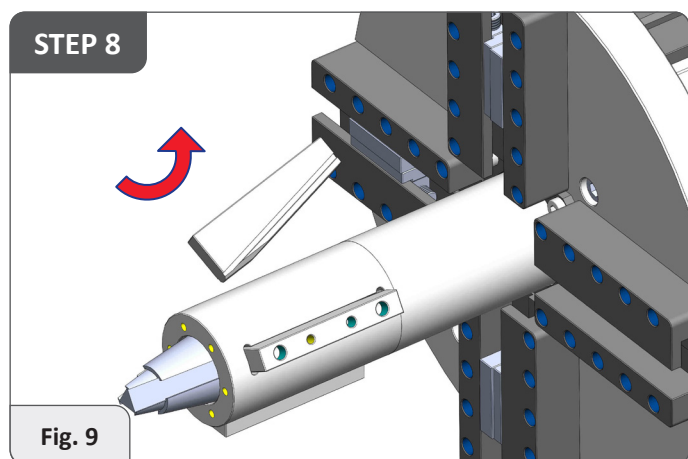

Remove the three extensions mounted as shown in the figure.

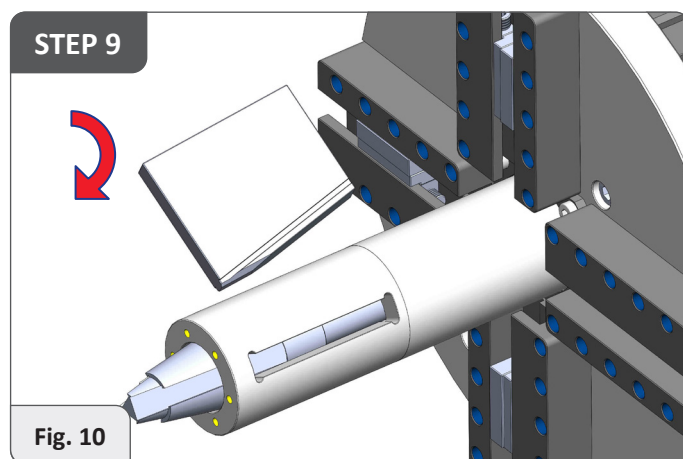

Insert the three extensions making like the previous in opposite movement.

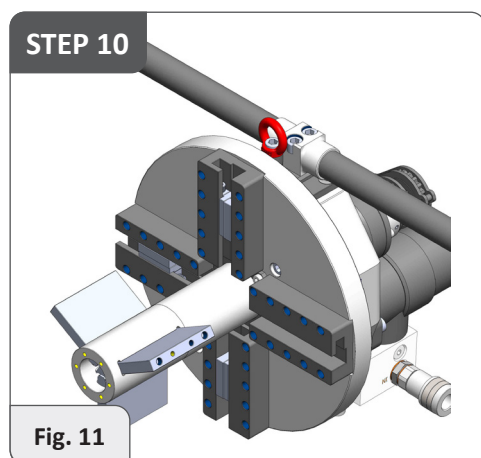

Once all 3 extensions have been inserted, use the key on the machine and move the expansion shaft back to the limit (hold the jaws during operation).

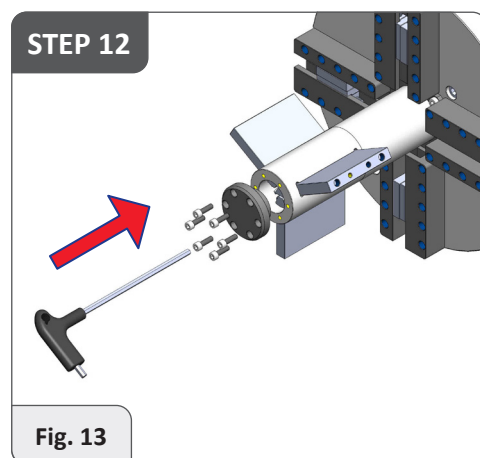
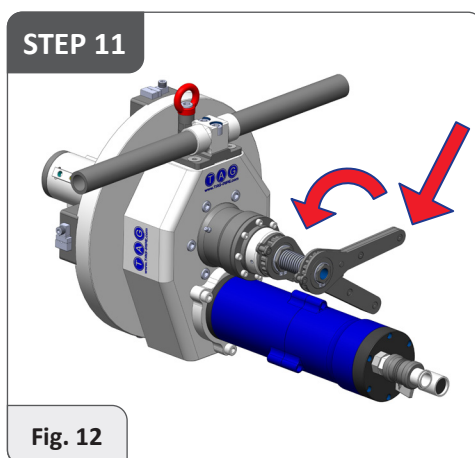

Reassemble the previously dismantled flange and screws by performing the opposite operations.

# STEP 13

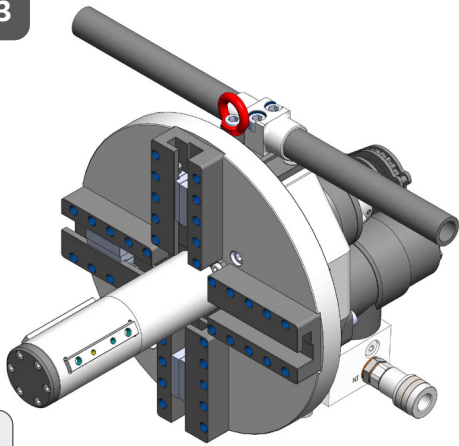

Fig. 14

Machine with Extension 0

# STEP 14

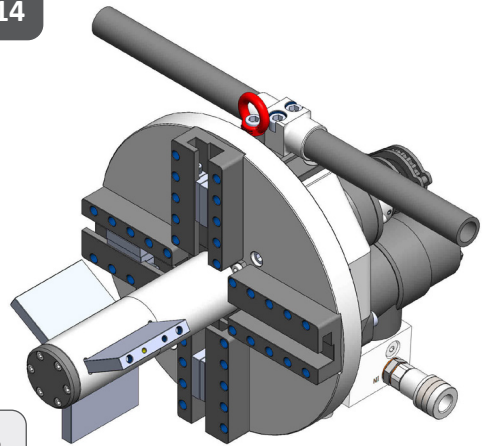

Fig. 15

Machine with Extension 1

Once you have assembled the correct extensions for the diameter to be machined, make sure to position the machine with the body fully backward in order to take advantage of the entire Feed stroke.

# STEP 15

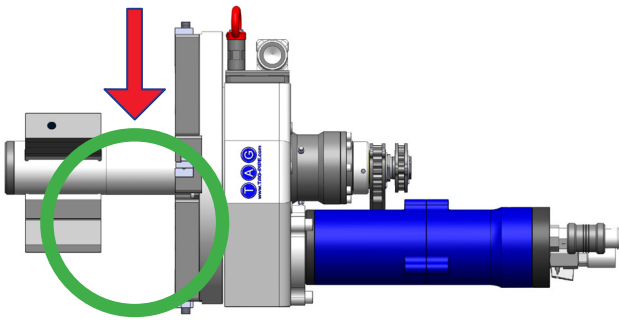

Fig. 16

YES

# STEP 16

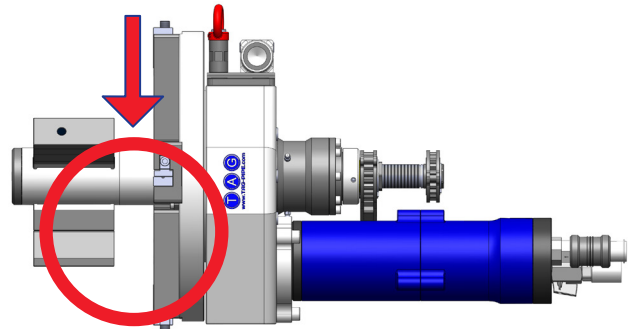

Fig. 17

NO

# STEP 17

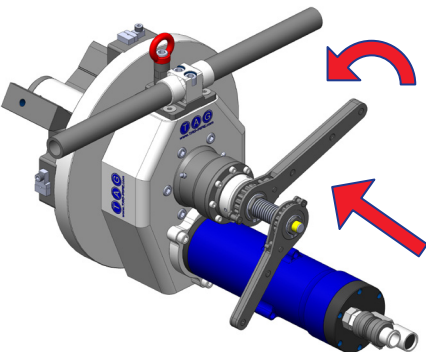

Fig. 18

If the body is not in the fully retracted position, act on the key on the machine (see figure) by turning it anticlockwise.

# STEP 18

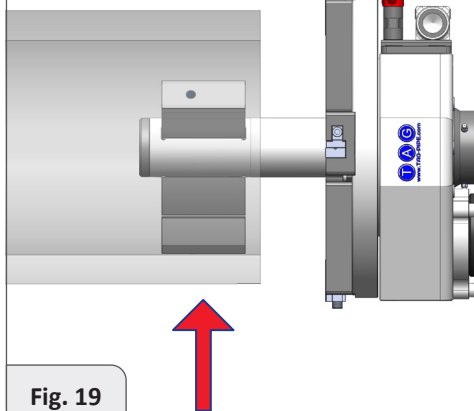

Fig. 19

Insert the machine inside the tube (15 - 20mm). Make sure that the jaws are inside the tube.

# STEP 19

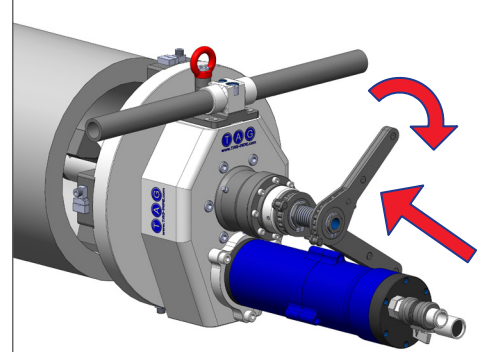
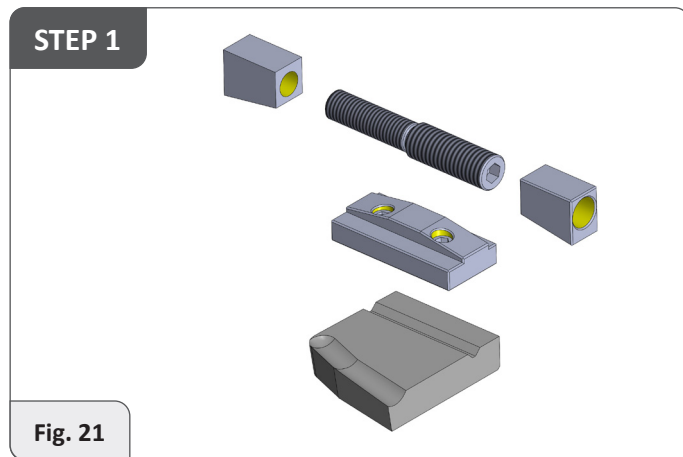

Fig. 20

Using the lever indicated in the images, lock the machine clockwise.

## 8.2 - TOOL SETUP

TAG offers 2 types of tools:



Formed Tools & Fittings Needed

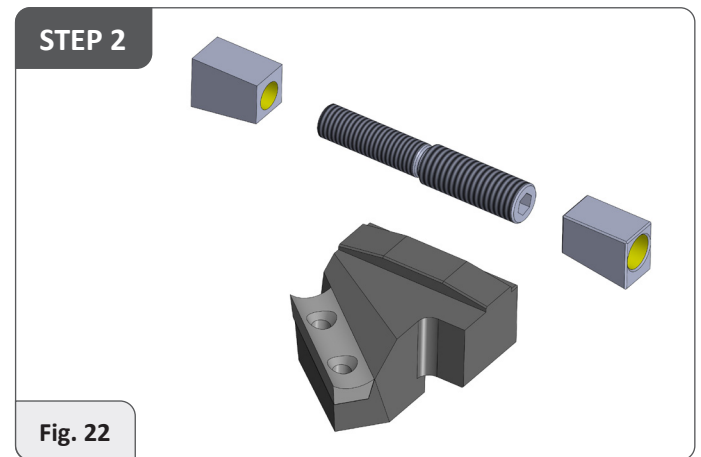

Insert Tools & Fittings Needed

Form Tools and Insert tool Holders require different fittings as per first pictures Ensure you have the correct fittings.

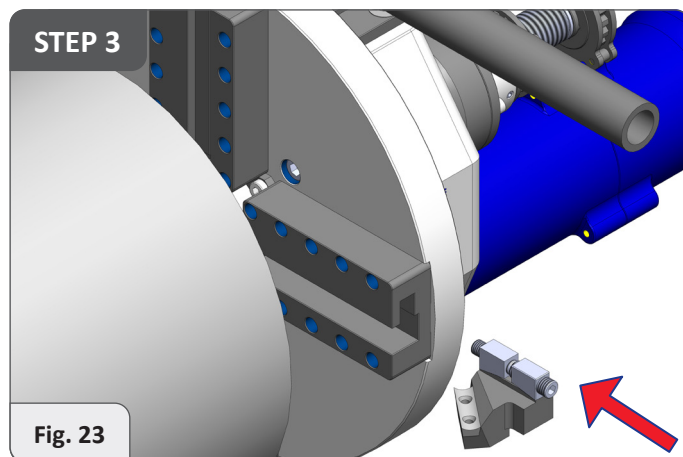

Insert the tool with its parts as in the photo.

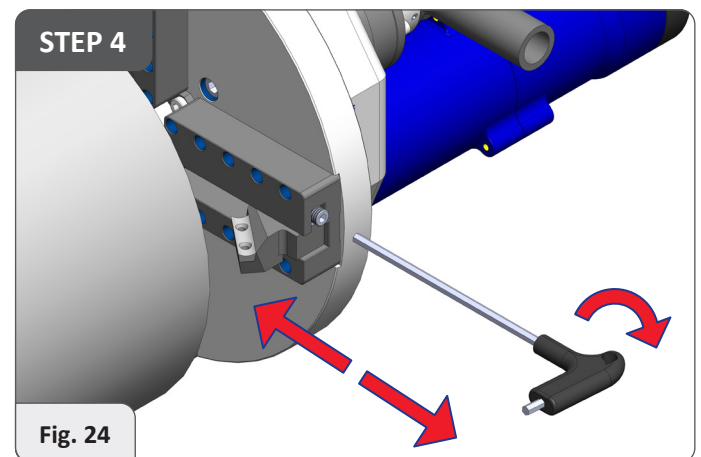

Position Tool in desired position and lock using 6mm allen key provided turning clockwise.

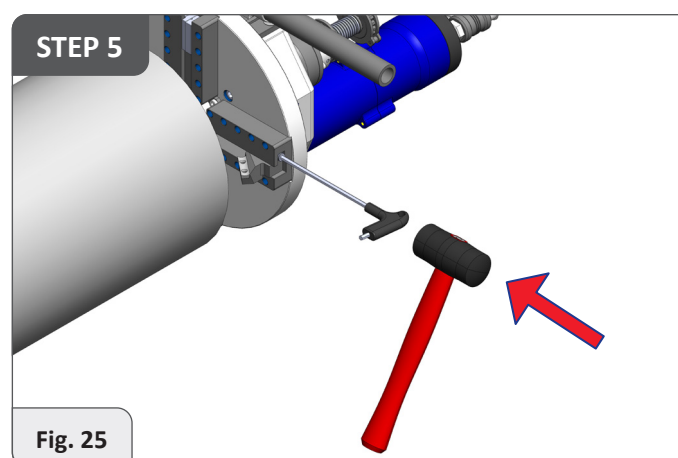

To unlock tool use 6mm allen key provided turn anti clockwise  $\frac{1}{2}$  a turn then tap end of allen key with rubber mallet this will release Tool and then pull back out.



8.3 - OPERATION

**⚠ IMPORTANT** Make sure that there is no obstacle blocking the rotation

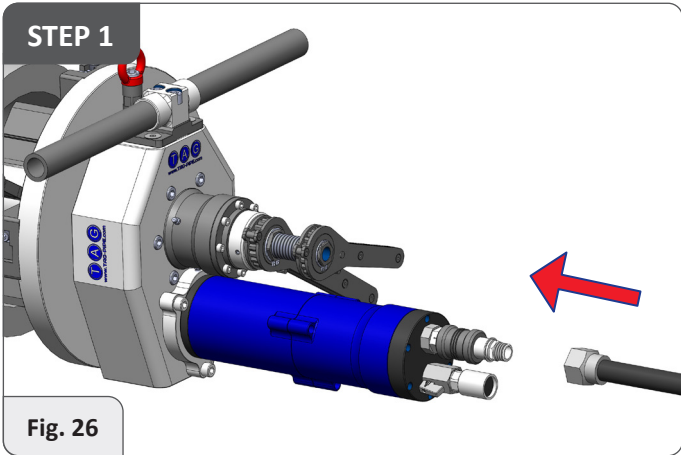

Connect the air hose to the machine pneumatic motor

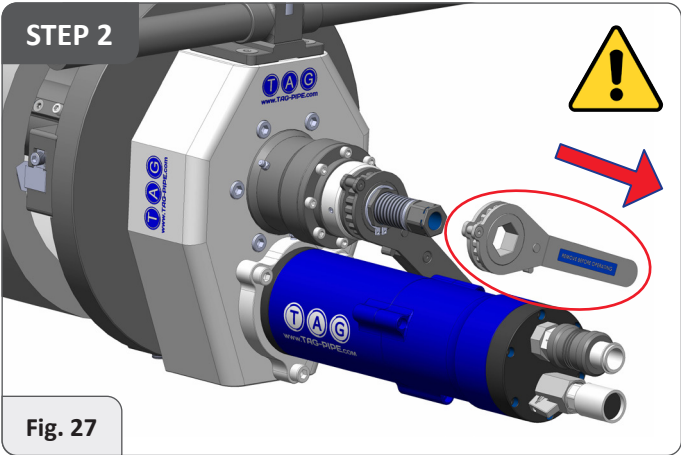

**⚠ IMPORTANT** Ensure you remove the Jaw Locking Key

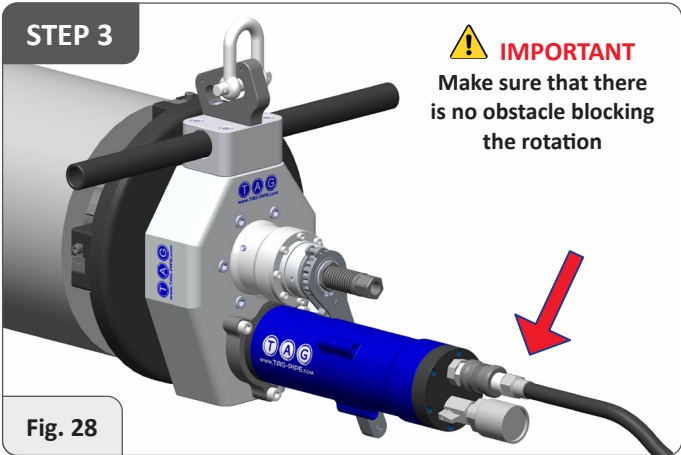

**⚠ IMPORTANT**  
Make sure that there is no obstacle blocking the rotation

Start the machine by acting on the air valve

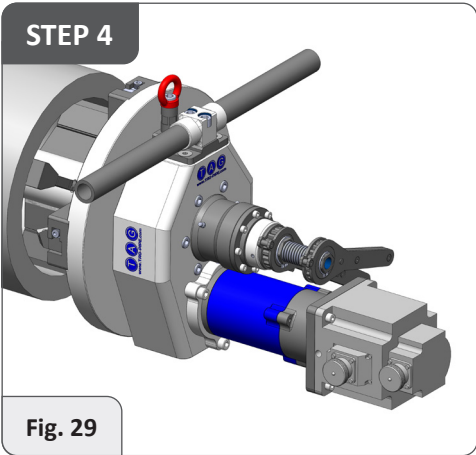

See the instructions in the single servo control kit

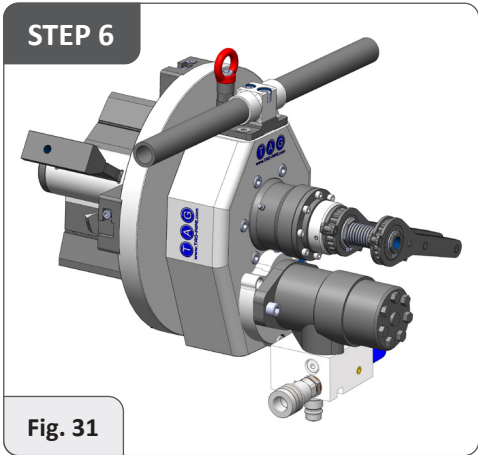
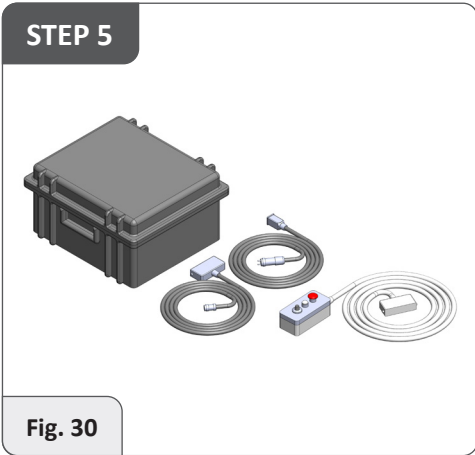

See instruction in the Hydraulic motor kit



## 8.4 - DRIVE KIT REPLACEMENT

From Pneumatic Drive Kit to Servo Electric Drive Kit

**!** Before replacing the transmission kits, make sure that you have eliminated any connections that may accidentally activate the machine

### STEP 1

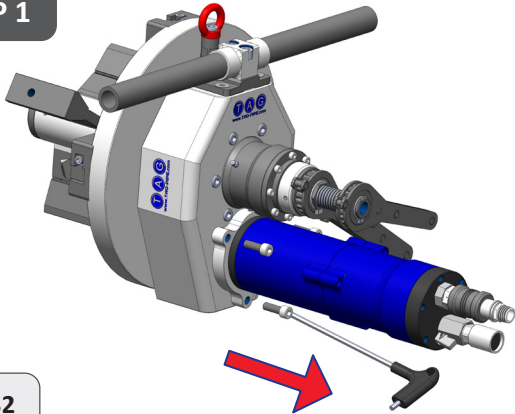

Fig. 32

Remove the 3 screws as shown in the image.

### STEP 2

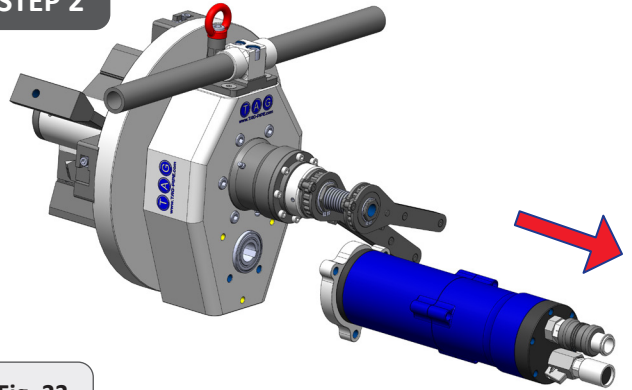

Fig. 33

Remove the pneumatic transmission kit.

### STEP 3

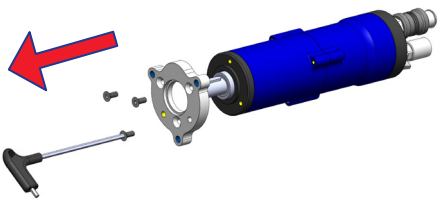

Fig. 34

Remove the 3 screws that join the flange to the motor and remove the same.

### STEP 4

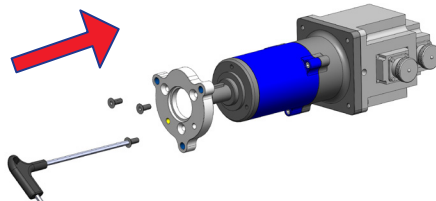

Fig. 35

The previously dismantled flange must now be assembled on to the electric transmission kit

### STEP 5

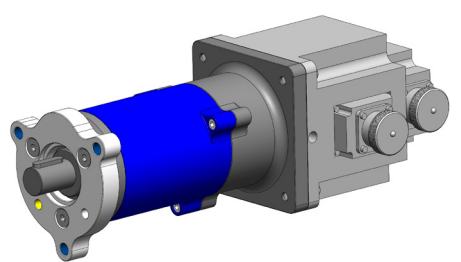

Fig. 36

### STEP 6

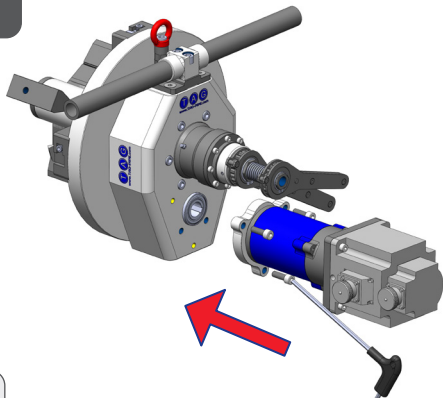

Fig. 37

### STEP 7

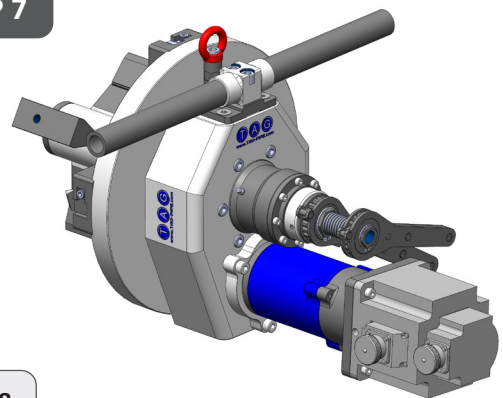
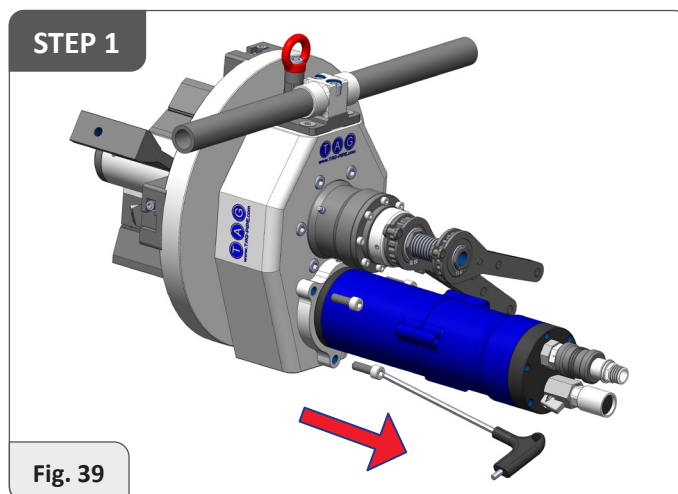
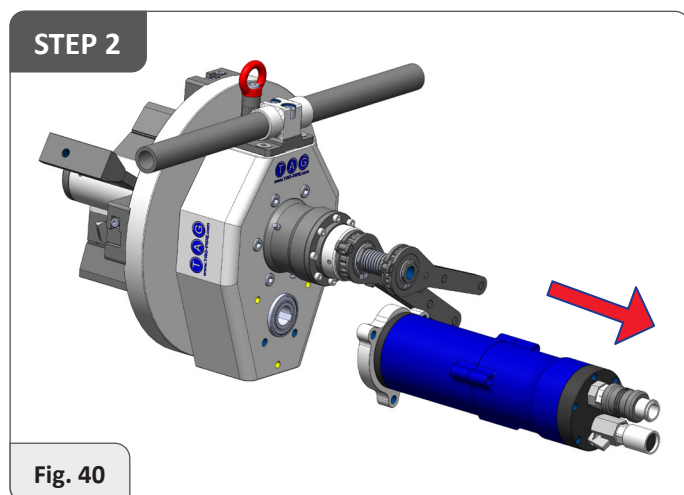

Fig. 38

Insert and screwing the 3 screws previously disassemble and assemble the transmission and servo electric kit.



Remove the 3 screws as indicated in the image.



Remove the pneumatic transmission kit.

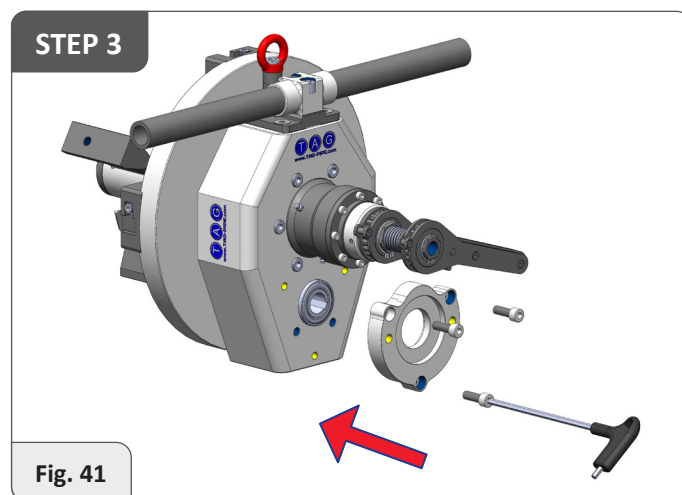

Assemble the flange using the 3 screws you removed previously.

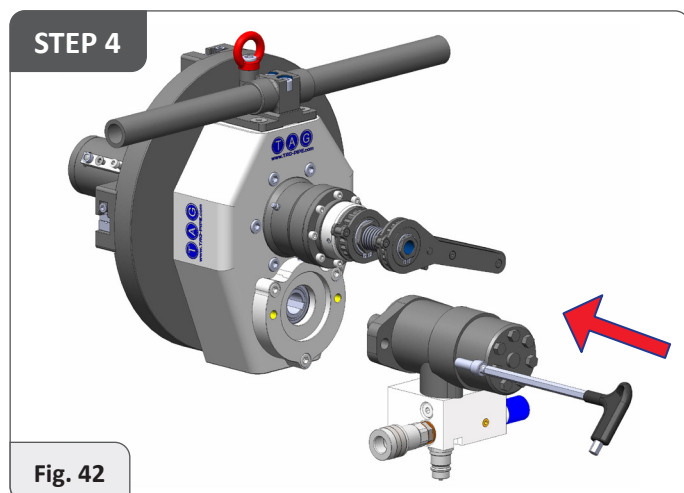

Insert the hydraulic transmission kit and start the 2 screws on the flange previously assembled.

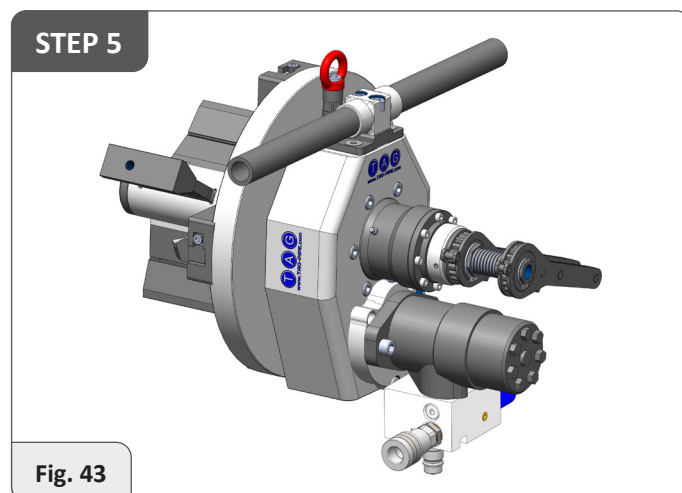

## 9 - PERIODIC MAINTENANCE AND REPAIR

Continued safe operation of the equipment depends on regular maintenance and testing of its operating and protective controls. The equipment should only be inspected, tested and maintained by qualified trained personnel.

Should any test indicate that the equipment being tested or observed is not in good operating condition, it should be repaired immediately. Record and maintain records of repairs or changes so that a complete record will be available for review at any time.

It is advisable to regularly check the machine for any deficiencies; in case of non-conformities, do not use the equipment and initiate repair activities. Any repair should be conducted by TAG Pipe or by a TAG Pipe authorised machine repair partner. All spare parts used during repair activities should be genuine TAG Pipe original spare parts. The warranty on the equipment voids in case any form of repair is conducted by any unauthorised individual or service provider and/or in case non-genuine spare parts are used during any form of repair activity.

### PERIODIC MAINTENANCE

- Prior to conducting any form of maintenance, make sure the equipment is not powered.
- When not using the equipment, keep the equipment safe and clean in the storage boxes.
- Do not store the equipment in humid storage area.
- Keep the equipment clean at all times in order to allow for optimal working conditions and performance.
- After use, the equipment should be thoroughly cleaned by brush and anti-rust spray or grease should be applied.
- Do not clean the equipment by using compressed air.
- Make sure no metal particles or swarf is remaining on any parts of the equipment.
- Before and after usage check all components, especially the power cords, and connecting hoses for pneumatic and hydraulic motors.
- Check the tension and accuracy of the toolboxes.  
The high precision feed and tolerance (0.1 mm feed per revolution) is of critical performance of the equipment.
- It is advised to conduct an annual inspection and formal maintenance check-up by TAG Pipe or any of its authorised service partners.



UNITED STATES HEAD OFFICE - HOUSTON



INTERNATIONAL HEAD OFFICE - FRANCE

### OUR BRANDS

 Where There's Pipe, There's Mathey! PIPE FLAME CUTTING AND BEVELLING PIPE ALIGNMENT AND REFORMING CLAMPS PIPE RIGGING EQUIPMENT www.MATHEY.COM	 The Pipe Fabricators Source PIPE JACK AND STANDS MEGA ROLLERS AND STANDS MATERIAL HANDLING EQUIPMENT www.BBPIPETOOLS.COM	 World Leading Manufacturer of Pipe Beveling and Cutting Machines PIPE BEVELLING MACHINES PIPE COLD CUTTING MACHINES www.TAG-PIPE.COM	 Innovative Orbital Solutions ORBITAL CUTTING / BEVELLING AND FACING ORBITAL WELDING www.AXXAIR.COM	 Purging Solutions for the perfect pipe weld! PIPE PURGING SYSTEMS PURGE OXYGEN MONITOR PIPE STOPPERS www.PURGEMASTERS.COM	 The Pipe Fitters Companion FIT-UP AND ALIGNMENT TOOLS LAYOUT AND MARKING TOOLS www.FIT-UP-PRO.COM
--	--	---	---	---	--



**SPECIALIZED FABRICATION EQUIPMENT**  
GROUP

## Global Locations:



### **S.F.E. GROUP HEAD OFFICE - USA**

#### **SPECIALIZED FABRICATION EQUIPMENT GROUP**

4433 South Drive,  
Houston,  
Texas 77053, USA

Tel: +1 713 747 8502

E-mail: [sales@sfe-brands.com](mailto:sales@sfe-brands.com)

### **S.F.E. GROUP HEAD OFFICE - FRANCE**

#### **SPECIALIZED FABRICATION EQUIPMENT GROUP**

330B Route de Portes Les Valence,  
ZI les Bosses,  
26800 Etoile-sur-Rhône, France

Tel: + 33 (0) 475 575 070

E-mail: [sales-int@sfe-brands.com](mailto:sales-int@sfe-brands.com)

### **SFE UNITED KINGDOM**

#### **SPECIALIZED FABRICATION EQUIPMENT GROUP**

Unit 15 & 16 Grendon Industrial Estate,  
Grendon Underwood, Aylesbury,  
Buckinghamshire, HP18 0QX England

Tel: +44 (0)1869 324 144

E-mail: [sales-uk@sfe-brands.com](mailto:sales-uk@sfe-brands.com)

### **SFE GERMANY**

#### **SPECIALIZED FABRICATION EQUIPMENT GROUP**

Ostmarkstrasse 15,  
76437 Rastatt,  
Germany

Tel: +49 (0)7222 9355100

E-mail: [sales-germany@sfe-brands.com](mailto:sales-germany@sfe-brands.com)

### **SFE KINGDOM OF SAUDI ARABIA**

#### **SPECIALIZED FABRICATION EQUIPMENT GROUP**

Warehouse No: EM16-10, Air Base Determinant,  
Industrial supply scheme, Ash Shulah, Dammam  
34264, Saudi Arabia

Tel: + 966 50 515 8196

E-mail: [sales-ksa@sfe-brands.com](mailto:sales-ksa@sfe-brands.com)

### **SFE MIDDLE EAST**

#### **SPECIALIZED FABRICATION EQUIPMENT GROUP**

Shams Freezone  
Sharjah

United Arab Emirates

Tel: +971 (0)50 217 1376

E-mail: [sales-me@sfe-brands.com](mailto:sales-me@sfe-brands.com)

### **SFE INDIA**

#### **SPECIALIZED FABRICATION EQUIPMENT GROUP**

Plot No. PAP 3, D 3 Block,  
Chinchwad, Pune 411 019

Mob: +91 90 1102 4332

Mob: +91 95 5258 4361

E-mail: [sales-india@sfe-brands.com](mailto:sales-india@sfe-brands.com)

### **SFE LATIN AMERICA**

#### **SPECIALIZED FABRICATION EQUIPMENT GROUP**

4433 South Drive,  
Houston,  
Texas 77053, USA

Tel: +1 713 747 8502

E-mail: [sales-latam@sfe-brands.com](mailto:sales-latam@sfe-brands.com)

### **SFE SOUTH KOREA**

#### **SPECIALIZED FABRICATION EQUIPMENT GROUP**

102 - 1301 Bucheon Technopark III  
421 - 742 Gyeonggi-do-seoul, Taehan-min'guk  
South Korea

Tel: +82 32 624 2870

E-mail: [sales-asia@sfe-brands.com](mailto:sales-asia@sfe-brands.com)

### **SFE VIETNAM**

#### **SPECIALIZED FABRICATION EQUIPMENT GROUP**

P1.2.13 Sky-Linked Villa, Diamond Alnata,  
Celadoncity, 89 Đường N1, P. Sơn Kỳ,  
Q. Tân Phú, TpHCM.

Tel: +84 91 951 70 18

E-mail: [sales-vietnam@sfe-brands.com](mailto:sales-vietnam@sfe-brands.com)

### **SFE CHINA**

#### **SPECIALIZED FABRICATION EQUIPMENT GROUP**

1208, 12F, #D 7001 Zhongchun RD  
Minhang District  
Shanghai, China

Tel: +86 215 429 1891

E-mail: [sales-china@sfe-brands.com](mailto:sales-china@sfe-brands.com)

Copyright © 2023 Specialized Fabrication Equipment Group, All rights reserved.

## OUR BRANDS

